

EROSION CONTROL STANDARD NOTES

- EXCAVATION, FILLING, GRADING AND STRIPPING SHALL BE PERMITTED TO BE UNDERTAKEN ONLY IN SUCH LOCATIONS AND IN SUCH A MANNER AS TO MINIMIZE THE POTENTIAL OF EROSION AND SEDIMENT AND THE THREAT TO THE HEALTH, SAFETY AND WELFARE OF NEIGHBORING PROPERTY OWNERS AND THE GENERAL PUBLIC.
- SITE PREPARATION AND CONSTRUCTION SHALL BE FITTED TO THE VEGETATION, TOPOGRAPHY AND OTHER NATURAL FEATURES OF THE SITE AND SHALL PRESERVE AS MANY OF THESE FEATURES AS FEASIBLE.
- THE CONTROL OF EROSION AND SEDIMENT SHALL BE A CONTINUOUS PROCESS UNDERTAKEN AS NECESSARY PRIOR TO, DURING AND AFTER SITE PREPARATION AND CONSTRUCTION.
- THE SMALLEST PRACTICAL AREA OF LAND SHALL BE EXPOSED BY SITE PREPARATION AT ANY GIVEN TIME.
- THE EXPOSURE OF AREAS BY SITE PREPARATION SHALL BE KEPT TO THE SHORTEST PRACTICAL PERIOD OF TIME PRIOR TO THE CONSTRUCTION OF STRUCTURES OR IMPROVEMENTS OR THE RESTORATION OF THE EXPOSED AREAS TO AN ATTRACTIVE NATURAL CONDITION.
- MULCHING OR TEMPORARY VEGETATION SUITABLE TO THE SITE SHALL BE USED WHERE NECESSARY TO PROTECT AREAS EXPOSED BY SITE PREPARATION, AND PERMANENT VEGETATION WHICH IS WELL ADAPTED TO THE SITE SHALL BE INSTALLED AS SOON AS PRACTICAL.
- WHERE SLOPES ARE TO BE REVEGETATED IN AREAS EXPOSED BY SITE PREPARATION, THE SLOPES SHALL NOT BE OF SUCH STEEPNESS THAT VEGETATION CANNOT BE READILY ESTABLISHED OR THAT PROBLEMS OF EROSION OR SEDIMENT MAY RESULT.
- SITE PREPARATION AND CONSTRUCTION SHALL NOT ADVERSELY AFFECT THE FREE FLOW OF WATER BY ENCRORCHING ON, BLOCKING OR RESTRICTING WATERCOURSES.
- ALL FILL MATERIAL SHALL BE COMPOSITION SUITABLE FOR THE ULTIMATE USE OF THE FILL, FREE OF RUBBISH AND CAREFULLY RESTRICTED IN ITS CONTENT OF BRUSH, STUMPS, TREE DEBRIS, ROCKS, FROZEN MATERIAL AND SOFT OR EASILY COMPRESSIBLE MATERIAL.
- FILL MATERIAL SHALL BE COMPACTED SUFFICIENTLY TO PREVENT PROBLEMS OF EROSION, AND WHERE THE MATERIAL IS TO SUPPORT STRUCTURES, IT SHALL BE COMPACTED TO A MINIMUM OF NINETY PERCENT (90%) OF STANDARD PROCTOR WITH PROPER MOISTURE CONTROL.
- ALL TOPSOIL WHICH IS EXCAVATED FROM A SITE SHALL BE STOCKPILED AND USED FOR THE RESTORATION OF THE SITE, AND SUCH STOCKPILES, WHERE NECESSARY, SHALL BE SEED OR OTHERWISE TREATED TO MINIMIZE THE EFFECTS OF EROSION.
- PRIOR TO, DURING AND AFTER SITE PREPARATION AND CONSTRUCTION, AN INTEGRATED DRAINAGE SYSTEM SHALL BE PROVIDED WHICH AT ALL TIMES MINIMIZES EROSION, SEDIMENT, HAZARDS OF SLOPE INSTABILITY AND ADVERSE EFFECT ON NEIGHBORING PROPERTY OWNERS.
- THE NATURAL DRAINAGE SYSTEM SHALL GENERALLY BE PRESERVED IN PREFERENCE TO MODIFICATIONS OF THIS SYSTEM, EXCEPTING WHERE SUCH MODIFICATIONS ARE NECESSARY TO REDUCE LEVELS OF EROSION AND SEDIMENT AND ADVERSE EFFECTS ON NEIGHBORING PROPERTY OWNERS.
- ALL DRAINAGE SYSTEMS SHALL BE DESIGNED TO HANDLE ADEQUATELY ANTICIPATED FLOWS, BOTH WITHIN THE SITE AND FROM THE ENTIRE UPSTREAM DRAINAGE BASIN.
- SUFFICIENT GRADES AND DRAINAGE FACILITIES SHALL BE PROVIDED TO PREVENT THE POONDING OF WATER. UNLESS SUCH POONDING IS PROPOSED WITHIN SITE PLANS, IN WHICH EVENT THERE SHALL BE SUFFICIENT WATER FLOW TO MAINTAIN PROPOSED WATER LEVELS AND TO AVOID STAGNATION.
- THERE SHALL BE PROVIDED WHERE NECESSARY TO MINIMIZE EROSION AND SEDIMENT SUCH MEASURES AS BENCHES, BERMS, TERRACES, DIVERSIONS AND SEDIMENT, DEBRIS AND RETENTION BASINS.
- DRAINAGE SYSTEMS, PLANTINGS AND OTHER EROSION OR SEDIMENT CONTROL DEVICES SHALL BE MAINTAINED AS FREQUENTLY AS NECESSARY TO PROVIDE ADEQUATE PROTECTION AGAINST EROSION AND SEDIMENT AND TO ENSURE THAT THE FREE FLOW OF WATER IS NOT OBSTRUCTED BY THE ACCUMULATION OF SILT, DEBRIS OR OTHER MATERIAL OR BY STRUCTURAL DAMAGE.

SPECIAL NOTE LOT #5
ANY BEDROCK REMOVAL SHALL BE COMPLETED USING MECHANICAL METHODS. NO BLASTING WILL BE ALLOW FOR THIS LOT.

06-1118B

FILED
10:34 AM
MAY 24 2008

NMA POSTUPACK
ULSTER COUNTY CLERK

40K

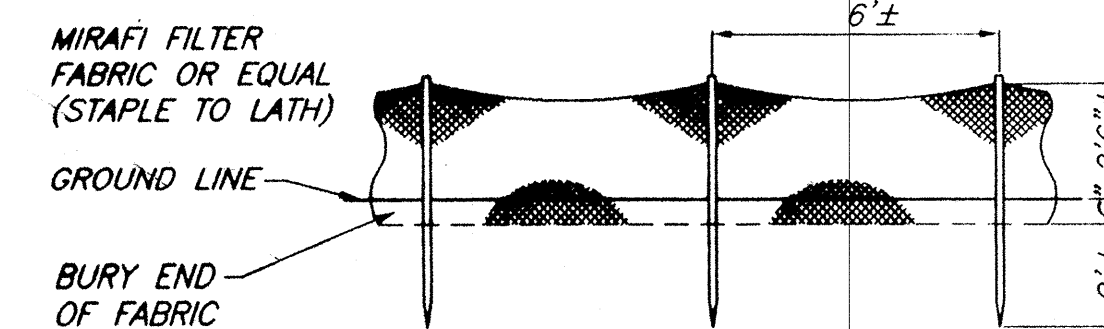

SILT FENCE DETAIL
N.T.S.

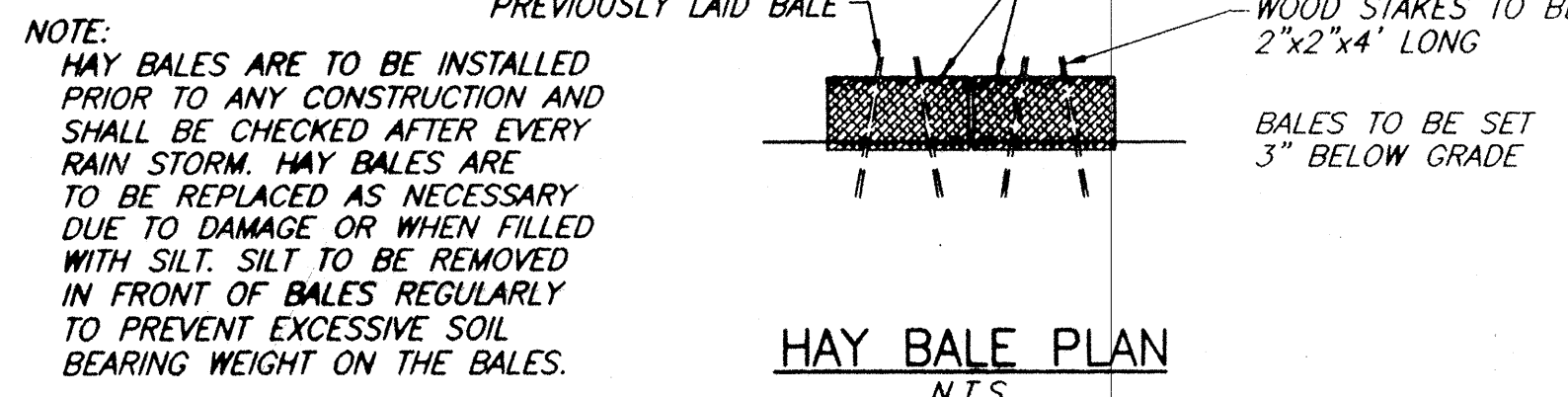

HAY BALE PLAN
N.T.S.

NOTE:
HAY BALES ARE TO BE INSTALLED PRIOR TO ANY CONSTRUCTION AND SHALL BE CHECKED AFTER EVERY RAIN STORM. HAY BALES ARE TO BE REPLACED AS NECESSARY DUE TO DAMAGE OR WHEN FILLED WITH SILT. SILT TO BE REMOVED IN FRONT OF BALES REGULARLY TO PREVENT EXCESSIVE SOIL BEARING WEIGHT ON THE BALES.

IT SHALL BE THE RESPONSIBILITY OF THE CONTRACTOR TO PROVIDE AND INITIALIZE EROSION CONTROL MEASURES, STRAW BALES ARE TO BE USED FOR SILTATION CONTROL AROUND ALL AREAS THAT WILL BE DISRUPTED DURING CONSTRUCTION, STRAW BALES ARE TO BE MAINTAINED TO THE SATISFACTION OF THE ENGINEER AND WILL BE REMOVED BY THE CONTRACTOR ONCE GROUND COVER IS REESTABLISHED.

- REVISED 04/05/06 PER PLANNING BOARD COMMENTS 04/03/06.
- REVISED 03/16/06 PER PLANNING BOARD COMMENTS 01/17/06.
- REVISED 12/15/05 PER PLANNING BOARD COMMENTS 12/05/05.
- REVISED 11/11/05 PER PLANNING BOARD COMMENTS.
- REVISED 09/23/05 PER PLANNING BOARD COMMENTS 09/23/05.
- REVISED 06/07/05 PER PLANNING BOARD COMMENTS 05/02/05.
- REVISED 4/15/05 PER PLANNING BOARD COMMENTS.
- REVISED 2/25/05 PER PLANNING BOARD COMMENTS.
- REVISED 8/19/04 PER PLANNING BOARD COMMENTS 7/19/04.
- REVISED 6/30/04 PER PLANNING BOARD COMMENTS 6/16/03.
- REVISED 1/25/04 PER U.C.H.D. COMMENTS

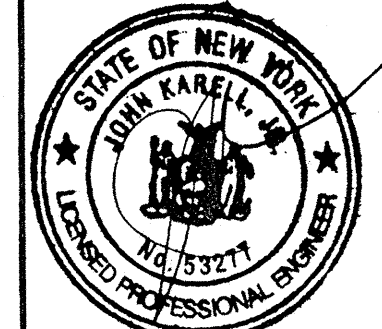
<p>ENGINEER</p> 	<p>FINAL PLAN</p> <p>LANDS OF GREINER-RESERVOIR RD. 5 LOT SUBDIVISION / LOT LINE CHANGE LOT LAYOUT SBL: 108.002-9-43.13 TOWN OF MARLBORO, ULSTER COUNTY, NY</p> <p>JK JOHN KARELL, JR., P.E. 2 SUMMIT COURT, SUITE 304 FISHKILL, N.Y. 12524 (845)-896-8896 (phone), (845)-896-1921 (fax)</p>
<p>DATE 4/4/03</p>	<p>SCALE 1" = 50'</p> <p>JOB NUMBER 23041-TOM</p> <p>SHEET NUMBER 2 OF 4</p>