

An aerial photograph of Milton Landing Park in Marlborough. The image shows a waterfront area with a road, a body of water, and a large area of dense trees. In the foreground, there are several large, white, cylindrical oil storage tanks. The text is overlaid on the image.

TOWN OF MARLBOROUGH MILTON LANDING PARK Waterfront revitalization transformation!

From an oil tank farm
to a town waterfront park.



Milton Land Park Master Plan—Adopted 2017



Town of Marlborough, NY

LOCAL WATERFRONT
REVITALIZATION
PROGRAM
COMPREHENSIVE PLAN
AND
DRAFT GENERIC
ENVIRONMENTAL
IMPACT STATEMENT



FEBRUARY 2020

PREPARED BY:



Town-wide
waterfront
revitalization
program (LWRP)
Adopted 2020.



Old South Pier



South Pier under reconstruction (Empire State Development Grant)



South Pier under reconstruction



Pier Reconstructed (Engineering by Tighe and Bond)



East of RR Tracks—Riverfront circa 2020



**Rosemary and Jerry Wein—Two of many long-time town volunteers for Milton Landing Shoreline reinforced by town/local contractor in 2023
Location of ADA-accessible kayak/canoe launch—installation underway.**



**Pathway and lawn planting by town.
Members of Advisory Committee and Design Team Site Planning Meeting**



Town Highway Preparing Park Site (below Watson Ave.) for Construction



**New Porous Paved Path and Granite Staircases to Watson Avenue Entrance of Park.
Completed Fall 2022**



Town Highway Installing Fill to Meet Site Grading Plan (view from Watson Ave.)





Milton Land Park Master Plan



Milton Land Park Master Plan—Construction Plan Next Phase

Aerial image of area for improvements (source google maps).

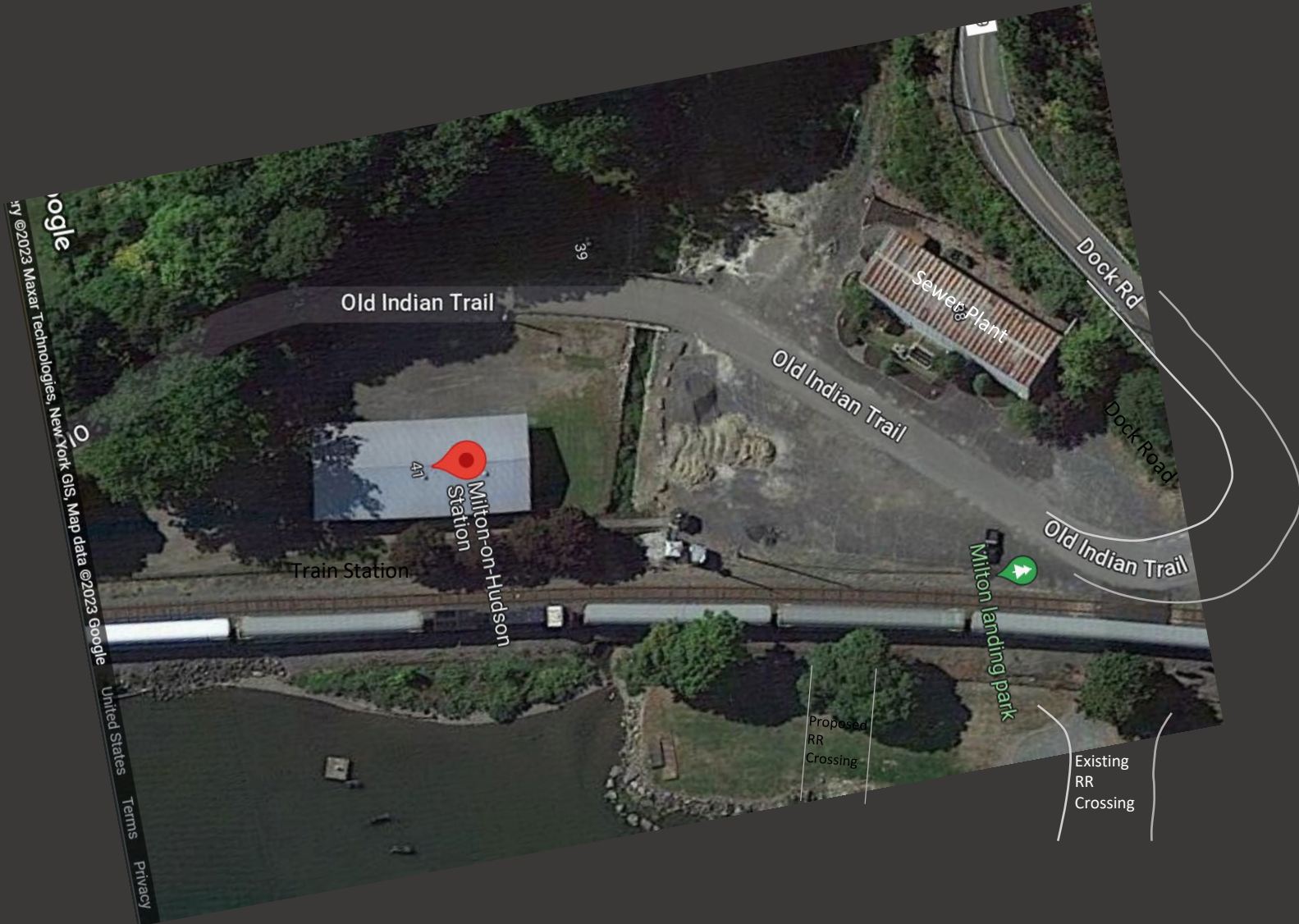

Site Plan by Behan Planning and Design, Landscape Architects
And Pitingaro and Doetsch, Engineers.

Project Oversight and Guidance by Town Board and Project Advisory Committee



SCALE:
0' 10' 20' 40'
1" = 20'



CALL BEFORE YOU DIG!
NEW YORK'S SURTIN, GLOE, TROTT, &
2. WORKING DAYS NOTICE BEFORE YOU DIG,
311-1-200-0000
Underground Utilities Call Center
1-800-245-2828

REV	DATE	DESCRIPTION	DESIGN	CHECK	DATE	APP
1	09/29/2022	ISSUED FOR PERMIT				



Pitingaro & Doetsch
Consulting Engineers, P.C.
15 Industrial Drive, Suite 2, Middletown NY 10941
(845) 703-8140

SITE PLAN
FOR
MILTON LANDING WATERFRONT REVITALIZATION
TOWN OF MARLBOROUGH, ULSTER COUNTY, NY

SHEET NO.
X OF X

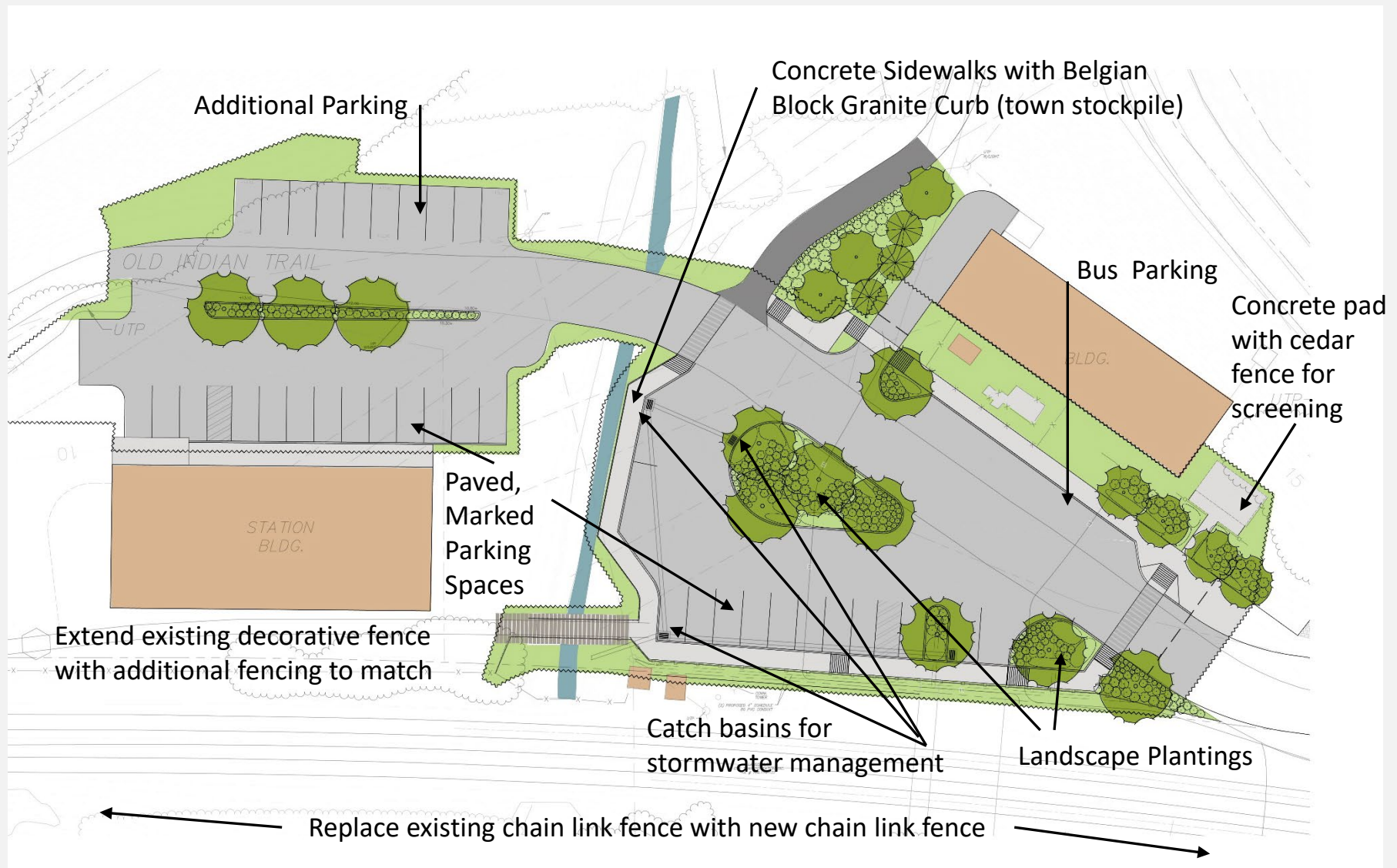

Revitalized Waterfront Vision

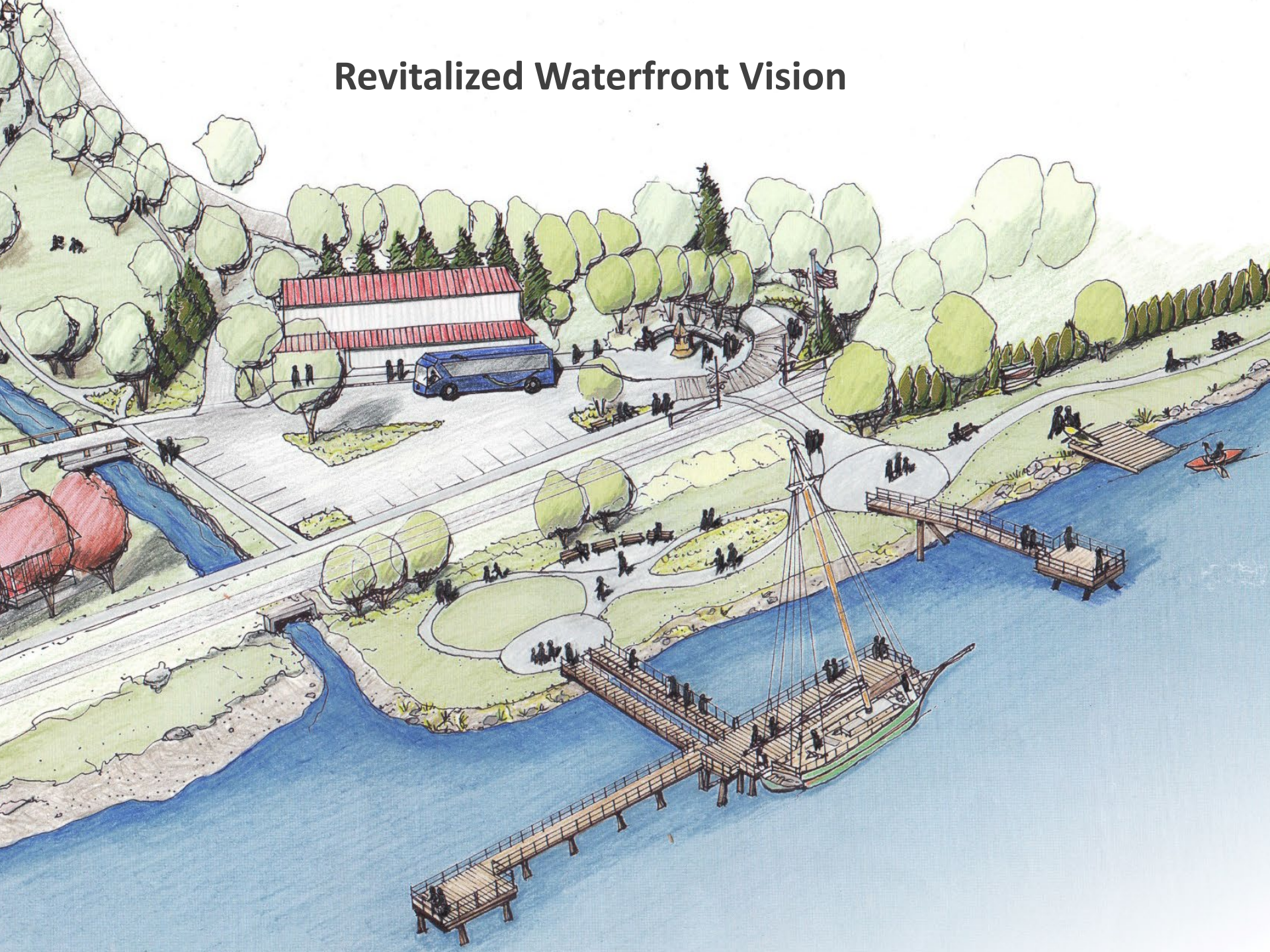

Community Volunteers, Advocates and Leadership

More than 10,000 volunteer hours have been donated to restore the historic train station at Milton-on-Hudson as well as extensive site and structure improvements.

Town elected and civic leaders have been collaborating for many years to see this project toward its ultimate vision for the community.

We recognize all of those past, current and future contributions toward re-connecting the community to the Hudson Riverfront.

Thank you!

The project construction documents were prepared with funding provided by the New York State Department of State under Title 11 of the Environmental Protection Fund